

HAHN+KOLB
GROUP



LET'S WORK TOGETHER.



ATORN EYE PROTECTION

Discover our new ATORN eye protection range.

DISCOVER IN THE
ONLINE SHOP NOW.



PERFORMANCE REQUIRES QUALITY...

...and quality requires performance.

Discover our modern and high-quality ATORN safety goggles range now. Whether safety glasses, overspecs or full-vision goggles - ATORN ensures that you are always on the safe side.

Anyone can offer eye protection. But outstanding performance and quality? Only ATORN can do that.

ATORN

Performance requires quality.

FIND OUT MORE ABOUT
HAHN+KOLB HERE



QUALITY CRITERIA AND MARKINGS

KEEPING A CLEAR VIEW - THE BASICS OF EYE PROTECTION

You can't see the future, even with safety goggles. But if your vision is not impaired, you can see any danger in front of you and that will give yourself enough time to get out of harm's way. Light is faster than sound! Your eyes are impressively powerful and always ready for use. Unfortunately, they are also extremely sensitive and, at this moment in time, irreplaceable. That's why we want to help you take good care of your eyes, so that you can see all the important moments in your life into the future.

Types of eye protection

We have three designs that are relevant to the market:

- Safety glasses
- Full-vision safety goggles
- Face protection

For safety glasses in particular, a distinction can be made between overspecs and safety glasses. The designs differ in performance with regard to their protective effect. Specialised designs include laser safety goggles, electrician's visors for work on low-voltage installations and welding protection for arc applications.

EYE PROTECTION MUST BE CERTIFIED IN ACCORDANCE WITH EN 166 AND MARKED WITH THE CE LOGO.

Eye protection primarily corresponds to personal protective equipment (PPE) Category II and must be marked in accordance with the standard on the frame and lens:

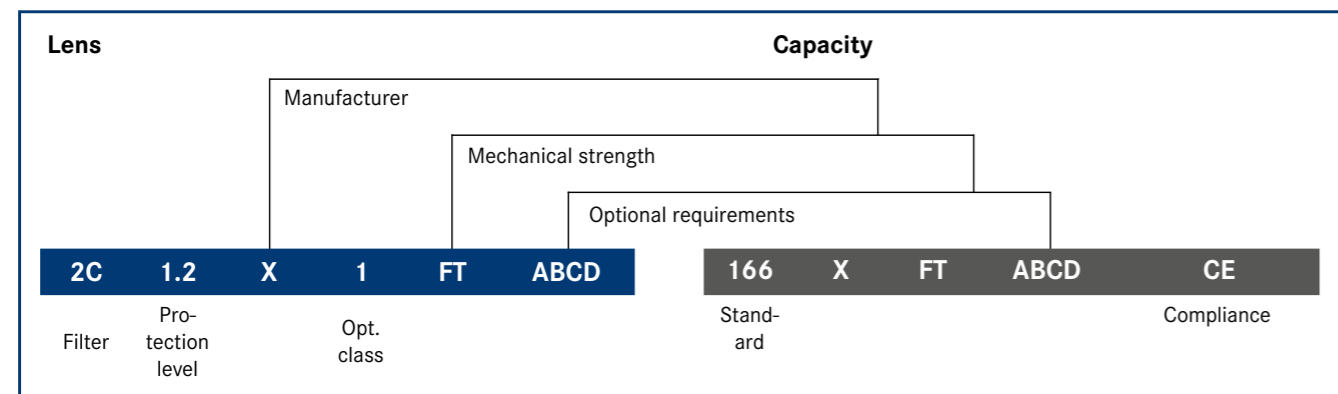

MECHANICAL STRENGTH - PROTECTION AGAINST FOREIGN OBJECTS MOVING AT HIGH SPEEDS

Mechanical risks are often evaluated incorrectly. Even the particles released by an angle grinder move through the air at 55-70 m/s. A professional brush cutter often surpasses the maximum of 190 m/s that can be tested in accordance with the standard.

MARKING	MEANING	SAFETY GLASSES	FULL-VISION SAFETY GOGGLES	FACE PROTECTION
S	Increased robustness	X	X	X
F	Low energy 45 m/s	X	X	X
B	Medium energy 120 m/s		X	X
A	High energy 190 m/s			X

In addition, mechanical strengths F, B and A can also be tested on tempered products (-5 °C and +55 °C). The letter T is added to the respective marking should this test be implemented.

PROTECTION AGAINST HARMFUL LIGHT

Strictly speaking, it is important to discuss both visible and invisible optical radiation. Visible optical radiation enables us to see and, in particular, to see colour. The predominant danger of this type of radiation is the risk of glare. Infrared (IR) and ultraviolet (UV) radiation are not visible, but can cause severe damage to the eyes

and skin in their own way. Using certified, properly positioned safety goggles with polycarbonate lenses (PC) - clear or tinted - your eyes are perfectly protected against damage caused by UV radiation. Tinting must only be used for protection against IR radiation or glare.

FILTER

FILTER STANDARD	MARKING	PROTECTION
EN 169	-	Gas welding (IR)
EN 170	2	UV radiation
EN 171	4	IR radiation/hot operations
EN 172	5/6	Sun protection (without/with IR)

In addition, the filters can also be checked for the visibility of signal colours. The letter C is added to the respective identification if it exists.

PROTECTION LEVELS

The specifications of the filter are supplemented by the respective protection level. The protection level is specified in decimals ranging from 1.1 to 13. The higher the value, the less light can reach the eye through the lens.

OPTICAL CLASSES

The standard distinguishes between optical classes 1, 2 and 3, whereby almost all products on the European market correspond to class 1 and are therefore suitable for long-term use (full working day).

OPTIONAL REQUIREMENTS

As an option, eye and face protection products can be certified with additional properties:

MARKING	MEANING	LENS/FRAME	SAFETY GLASSES	FULL-VISION SAFETY GOGGLES	FACE PROTECTION
K	Scratch resistance	X/-	X	X	X
N	Mist-free	X/-	X	X	X
3	Liquids (drops and splashes)	-/X		X	X
4	Coarse dust	-/X		X	
5	Fine dust, gases, aerosols	-/X		X	
8	Arcing	X/X			X
9	Molten substances, hot solids	X/X		X	X
H	Small head shape	X/X	X	X	
R	Increased IR reflection	X/-	X	X	X

A-VIEW 1 THE ALL-ROUNDER

A-VIEW 1

DESIGN

- Sporty safety glasses with state-of-the-art lens geometry for maximum protection
- Perfect eye area coverage due to extended side protection
- Individually adjustable arm length and angle for maximum comfort and a perfect fit
- Adjustable, soft nose bridge and soft multi-component arm technology ensure that they can be worn in a pressure-free and non-slip manner
- Frame designation EN166 F T CE



APPLICATION

Grinding, turning and milling work, precision engineering, workshop, installation and laboratory work.

TECHNICAL DATA

- Category: II
- EN standard: 166 | 170
- Model: A-View 1
- Lens marking: 2C-1.2 MX 1 FTKN
- Lens material: polycarbonate
- Coating: clear HC
- Colour of lens: clear
- Anti-fog: yes
- Scratch-resistant: yes
- UV protection: 400 nm
- Version: adjustable arm length | adjustable arm inclination
- Weight: 28 g
- Colour: blue | grey

55690... 001

A-VIEW 2

THE FLEXIBLE ONE

A-VIEW 2

DESIGN

- Very light, innovative safety glasses in a sporty design
- Unique, individual adjustment of the arm width to the required head size
- Wrap-around lens for maximum front and side protection
- Soft nose bridge and soft padded arm ends ensure that they can be worn in a pressure-free and non-slip manner
- Frame designation EN166 F CE



APPLICATION

Grinding, turning and milling work, precision engineering, workshop, installation and laboratory work.

ONE TWIST AND THE GLASSES FIT

One twist and the glasses fit perfectly

Depending on the adjustment, the rotating mechanism affects the distance between the arm ends.

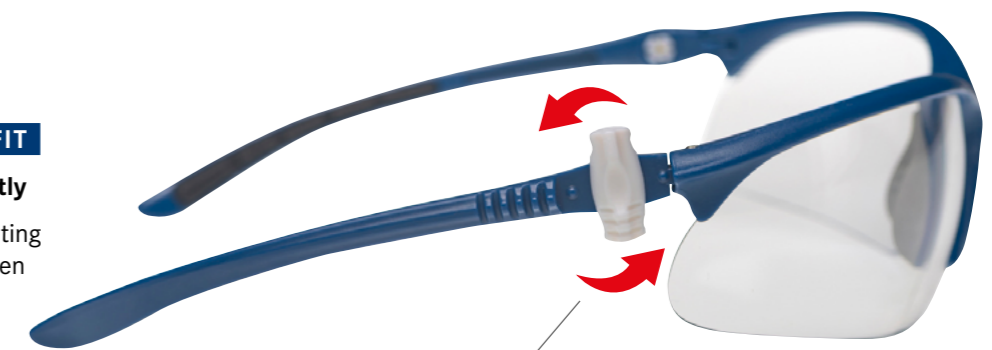

FLEXIBLE ADJUSTMENT

The A-View 2 offers a secure grip and high wearing comfort in daily continuous use, regardless of the head shape.



TECHNICAL DATA

- Category: II
- EN standard: 166 | 170
- Model: A-View 2
- Lens marking: 2C-1.2 MX 1 FK
- Lens material: polycarbonate
- Coating: clear HC
- Colour of lens: clear
- Anti-fog: no
- Scratch-resistant: yes
- UV protection: 400 nm
- Weight: 26 g
- Colour: blue | grey | white

55690...

002



A-VIEW 3

THE ROBUST ONE

A-VIEW 3

DESIGN

- Robust safetyglasses for heavy industrial use
- Additional soft, multi-component sealing lip in the eyebrow area to protect against foreign objects entering from above
- Vents in the seal area ensure excellent air circulation
- Individually adjustable arm angle for maximum comfort and a perfect fit
- Soft nose bridge and rubberised arm ends ensure that they can be worn in a pressure-free and non-slip manner
- Frame designation EN166 F CE

APPLICATION

Grinding, turning and milling work, precision engineering, workshop, installation and laboratory work.

TECHNICAL DATA

- Category: II
- EN standard: 166 | 170
- Model: A-View 3
- Lens marking: 2C-1.2 MX 1 FK
- Lens material: polycarbonate
- Coating: clear HC
- Colour of lens: clear
- Anti-fog: no
- Scratch-resistant: yes
- UV protection: 400 nm
- Version: adjustable arm inclination
- Weight: 35 g
- Colour: blue | grey

55690... 003



A-VIEW 4

THE VERSATILE ONE

A-VIEW 4

DESIGN

- Very lightweight safety glasses for visitors and for use as overspecs with excellent side and upper protection
- Suitable for wearing over conventional prescription glasses
- Ergonomically designed, narrow arms fit the head without applying pressure
- Individually adjustable arm angle for maximum comfort and a perfect fit
- Frame designation EN166 F CE

APPLICATION

For visitors, as overspecs, for grinding, turning and milling work, precision engineering, installation and laboratory work.

TECHNICAL DATA

- Category: II
- EN standard: 166 | 170
- Model: A-View 4
- Lens marking: 2C-1.2 MX 1 FTK
- Lens material: polycarbonate
- Coating: clear HC
- Colour of lens: clear
- Anti-fog: no
- Scratch-resistant: yes
- UV protection: 400 nm
- Version: adjustable arm inclination
- Weight: 32 g
- Colour: blue | white

55690... 004

A-VIEW 5

THE SECURE ONE

A-VIEW 5

DESIGN

- Trendy full-vision goggles with a very soft face pad that provides a tight seal without pressure points
- Large lens with unrestricted side view
- Tight fit with indirect ventilation to prevent the lens from fogging
- Wide, individually adjustable head harness for maximum comfort and a perfect fit
- Suitable for wearing over conventional prescription glasses
- Frame designation EN166 B 3 CE

APPLICATION

Grinding, installation and laboratory work, protection against dust, liquids and mechanical hazards.
Suitable for wearing as overspecs.



TECHNICAL DATA

- Category: II
- EN standard: 166 | 170
- Model: A-View 5
- Lens marking: 2C-1.2 MX 1 BKN
- Lens material: polycarbonate
- Coating: clear HC
- Colour of lens: clear
- Anti-fog: yes
- Scratch-resistant: yes
- UV protection: 400 nm
- Weight: 160 g
- Colour: blue | white

55690...

005

OUR **ATORN** PORTFOLIO

IN THE PERSONAL PROTECTIVE EQUIPMENT RANGE

ATORN HAND PROTECTION

Whether working in assembly areas or with cutting hazards - ATORN gloves offer you a perfect fit, top quality and maximum performance for daily use. In the process, we do away with unnecessary plastic packaging and accept our responsibility towards the environment.

DISCOVER THE ATORN
HAND PROTECTION IN
OUR ONLINE SHOP NOW:



ATORN HEARING PROTECTION

Discover our modern and high-quality ATORN hearing protection range. You have the choice: Whether you are looking for ear plugs, ear plug dispensers, reusable corded ear plugs, banded ear plugs or ear defenders - we have everything you need!

DISCOVER ATORN HEARING
PROTECTION IN OUR
ONLINE SHOP NOW:



OUR QUALITY BRAND

ATORN

Performance requires quality.

WIDE ASSORTMENT. RELIABLE QUALITY. DELIVERABLE AT ANY TIME.

With over 33,000 items available, including drilling, milling, turning, grinding and cutting tools, as well as hand tools, measuring equipment, workshop supplies, personal protective equipment and workshop equipment, ATORN offers a wide assortment of products and is constantly adding new items. Our particular focus is on the precision and durability offered by our products. Due to the way our company is structured, we can offer products that deliver the ideal price/performance ratio. In fact, our range of products leaves nothing to be desired.

NOT JUST A VISION

When we have ideas for new products, they do not stay in the realm of fantasy - we steadfastly follow them through until we end up with something ready for the market. In the past few years, we have developed a number of pioneering innovations.

PERFORMANCE REQUIRES QUALITY AND QUALITY REQUIRES PERFORMANCE.

Discover our modern and high-quality ATORN safety eyewear range now. With ATORN, whether you wear safety glasses or full-vision goggles, you will always be on the safe side.

NEW NOW!





FIND OUT MORE:
WWW.HAHN-KOLB.COM



EMAIL CONSULTATION:
ONLINE@HAHN-KOLB.DE



TELEPHONE CONSULTATION:
0800 9813-188



NEWSLETTER:
SUBSCRIBE NOW AND DON'T MISS ANY
PROMOTIONS OR NEWS FROM HAHN+KOLB.

Visit us at:



HAHN+KOLB
GROUP

LET'S WORK TOGETHER.



HAHN+KOLB WERKZEUGE GMBH

Schlieffenstraße 40
71636 Ludwigsburg,
Germany

www.hahn-kolb.de
info@hahn-kolb.de
Tel. 07141 498 40

The current terms and conditions of HAHN+KOLB
Werkzeuge GmbH apply.

©2024 HAHN+KOLB Werkzeuge GmbH
No. 7303